

CZ0201 防爆开关模块
主要数据 Main technical data:

认证 Certification | 防爆标志 Ex mark | 符合标准 Meet the standard

China (PCEC Ex)	Ex de II C	GB3836 GB12476
IECEX	Ex de II C	IEC60079
ATEX	Ⓜ II 2GD Ex de II C	EN60079

适用范围: 用于 1 区和 2 区

 使用环境温度: -40°C to $+55^{\circ}\text{C}$

 工作温度: -40°C .. $+90^{\circ}\text{C}$

防护等级: IP20

额定电压: 250V 250V 110V 24V

使用类别: AC12 AC15 DC13 DC13

额定电流: 16A 10A 0.5A 1A

 环境温度: $T_a < 40^{\circ}\text{C}$ $T_a < 60^{\circ}\text{C}$ $T_a < 60^{\circ}\text{C}$ $T_a < 60^{\circ}\text{C}$

 接线端子: $2 \times 2.5\text{mm}^2$

机械寿命: 100万次

 板前导轨型安装: 导轨 $\text{TS}35 \times 7.5$ 或螺钉固定

板后型安装: 在 1-6mm 面板上

符合: CE 0575

CZ0201 Explosion-proof switch module

Intended use: Can be used in zone 1 and zone 2

 Ambient temperature use: -40°C to $+55^{\circ}\text{C}$

 Operating temperature: -40°C .. $+90^{\circ}\text{C}$

Degree of protection: IP20

Rated voltage: 250V 250V 110V 24V

Regimentation use: AC12 AC15 DC13 DC13

Rated current: 16A 10A 0.5A 1A

 Ambient temperature: $T_a < 40^{\circ}\text{C}$ $T_a < 60^{\circ}\text{C}$ $T_a < 60^{\circ}\text{C}$ $T_a < 60^{\circ}\text{C}$

 Terminals: $2 \times 2.5\text{mm}^2$

Mechanical life: 100, 0000 times

 Board front mounting rail type mounting: May be held on mounting rails $\text{TS}35 \times 7.5$ or with screws

Board back type mounting: On 1-6mm panel

Conformity to: CE 0575

P□/K□/□/...系列操作头
主要数据 Main technical data:

认证 Certification | 防爆标志 Ex mark | 符合标准 Meet the standard

China (PCEC Ex)	Ex e II	GB3836 GB12476
IECEX	Ex e II Ex tD A21	IEC60079
ATEX	Ⓜ II 2GD Ex e II Ex tD A21	EN60079

适用范围: 用于 1 区和 2 区, 21 区和 22 区

 使用环境温度: $-40^{\circ}\text{C} < T_a < 55^{\circ}\text{C}$

防护等级: IP66

材料: 聚酰胺

符合: CE 0575

P□/K□/□/...Series operation head

Intended use: Can be used in zone 1 and zone 2

Can be used in zone 21 and zone 22

 Ambient temperature use: $-40^{\circ}\text{C} < T_a < 55^{\circ}\text{C}$





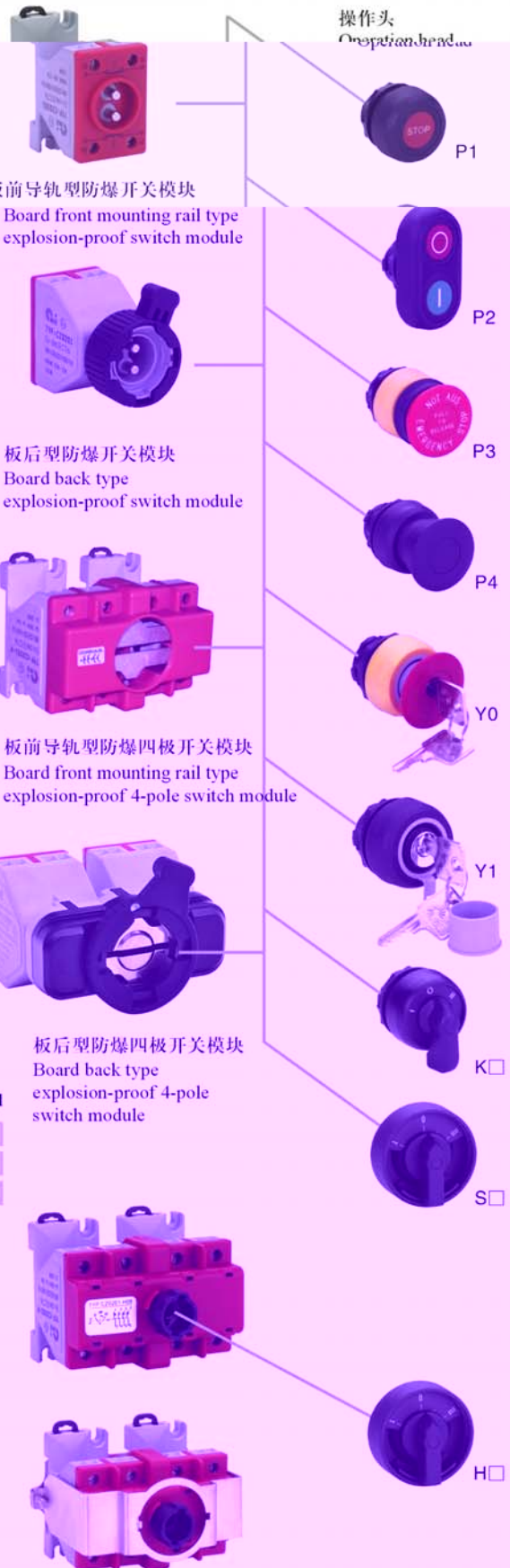

Degree of protection: IP66

Material: polyamide

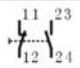
Conformity to: CE 0575

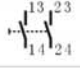
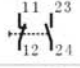
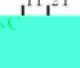

• 订购规格 Order specifications:

图样 Illustration	结构形式 Construction type	型号 Type	按钮触点 Button contact	订购号(编码) Order No.(Code)
	板前导轨型 Board front mounting rail type	P1 橡胶按钮 P1 Rubber sheath button	 11 23 12 24 INC/INO	P1 60 □□
			 11 21 12 22 2NC	P1 61 □□
			 13 23 14 24 2NO	P1 62 □□
			 11 23 12 24 INC/INO	P1 70 □□
			 11 21 12 22 2NC	P1 71 □□
	板后型 Board back type	P1 橡胶按钮 P1 Rubber sheath button	 11 21 12 22 2NO	P1 72 □□
			 11 23 12 24 INC/INO	P2 60 □□ / □□
			 11 21 12 22 2NC	P2 61 □□ / □□

A

• 订购规格 Order specifications:

图样 Illustration	结构形式 Construction type	型号 Type	按钮触点 Button contact	订购号(编码) Order No.(Code)	
	板前导轨型 Board front mounting rail type	P3 急停自锁按钮 P3 Emergency self-locking button	11 23 12 24	INC/INO	P3 60
			11 21 12 22	2NC	P3 61
			13 23 14 24	2NO	P3 62
	板后型 Board back type		11 23 12 24	INC/INO	P3 70
			11 21 12 22	2NC	P3 71
			13 23 14 24	2NO	P3 72
	板前导轨型 Board front mounting rail type	P4 黑色蘑菇头按钮 P4 Black mushroom head button	11 23 12 24	INC/INO	P4 60□□
			11 21 12 22	2NC	P4 61□□
			13 23 14 24	2NO	P4 62□□
	板后型 Board back type		11 23 12 24	INC/INO	P4 70□□
			11 21 12 22	2NC	P4 71□□
			13 23 14 24	2NO	P4 72□□
	板前导轨型 Board front mounting rail type	Y0 带钥匙红色蘑菇头按钮 Y0 Red mushroom button with key	11 23 12 24	INC/INO	Y0 60
			11 21 12 22	2NC	Y0 61
			13 23 14 24	2NO	Y0 62
	板后型 Board back type		11 23 12 24	INC/INO	Y0 70
			11 21 12 22	2NC	Y0 71
			13 23 14 24	2NO	Y0 72
	板前导轨型 Board front mounting rail type	Y1 带钥匙按钮 Y1 Button with key	11 23 12 24	INC/INO	Y1 60
			11 21 12 22	2NC	Y1 61
			13 23 14 24	2NO	Y1 62
	板后型 Board back type		11 23 12 24	INC/INO	Y1 70
			11 21 12 22	2NC	Y1 71
			13 23 14 24	2NO	Y1 72

A

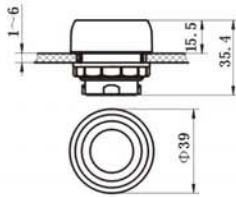
外形尺寸 Outline dimensions:

P1 橡胶套按钮操作头
P1 Operation head of rubber sheath button

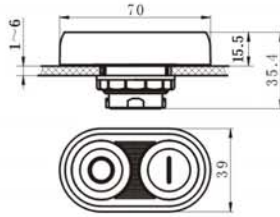

P2 橡胶套双按钮操作头
P2 Operation head of rubber sheath double button

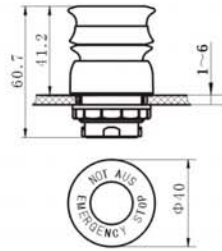

P3 急停自锁按钮操作头
P3 Operation head of emergency self-locking button

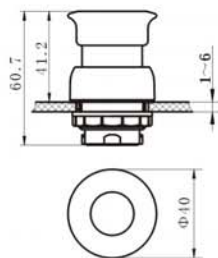

P4 黑色蘑菇头按钮操作头
P4 Operation head of black mushroom head button

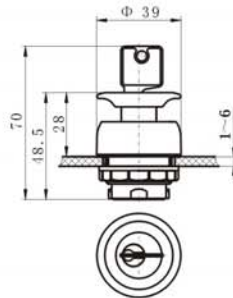

Y0 带钥匙红色蘑菇头按钮操作头
Y0 Operation head of red mushroom button with key

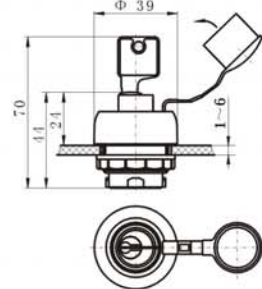

Y1 带钥匙按钮操作头
Y1 Operation head of button with key

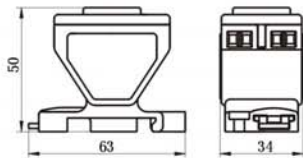

CZ0201 板前导轨型防爆开关模块
CZ0201 Broad front mounting rail type explosion-proof switch module

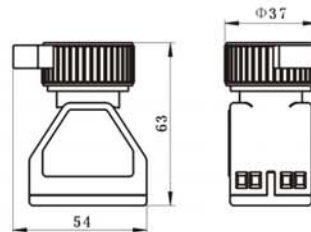

CZ0201 板后型防爆开关模块
CZ0201 Board back type explosion-proof switch module

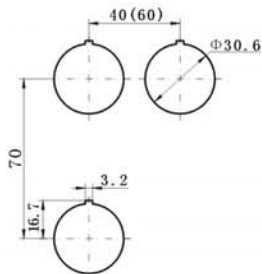
安装间距 Mounting pitches:

板后型配操作头外形尺寸

Outline dimensions of board back type with operation head

